

TECHNICAL DATA LIST March 2007

Technical data and prices



Part no.	Outside cone D1 – D2 (mm) For internal pipe diameter	Internal hole diameter d (mm)
T14	12 - 14	9
T16	14 - 16	11
T18	16 - 18	13
T20	18 - 20	15
T22	19 - 23	17
T25	23 - 25	20
T28	25 - 28	23
T30	26 - 30	24
T33	30 - 34	27
T36	34 - 38	31
T40	38 - 42	34
T45	42 - 46	38
T50	46 - 52	44

Wipco Teknikk AS reserves the right to make technical changes without prior warning.

TECHNICAL DATA LIST March 2007

CABLE AND HOSE PROTECTION GLANDS

Product group T



The cable and hose protection glands from WIPCO gives an efficient protection of electrical cables and hoses, when drawn through metal pipes and sheets.

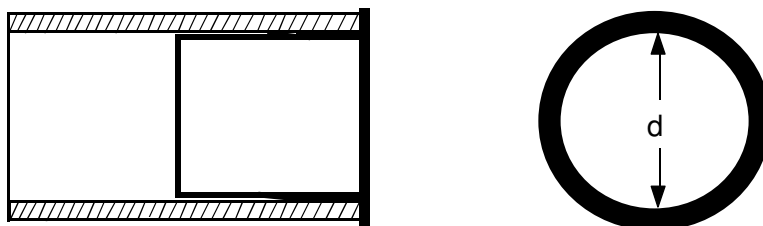

By using the cable and hose protection glands at the pipe ends or in a hole in a metal sheet, where sharp edges can occur due to cutting or locking the hole, the insulation on the electrical cable or the outside layer on the hose will be protected against damage.

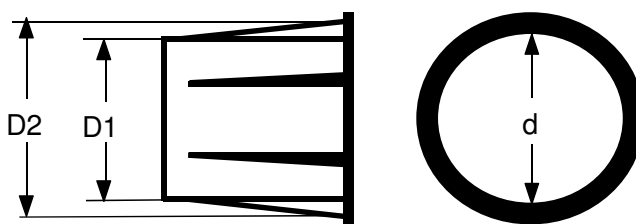

The cable and hose protectors have outside conical strips which makes them fit several inside pipe or hole diameters.

The cable and hose protectors can also be cut on one side, split open and placed around the electrical cable or hose and then forced into the pipe or hole if the cable already is drawn through.

The cable and hose protectors are made of heavy duty Polyethylene LD, in the black colour.